

# LITETRONICS®

## Strip Fixture Wire Harness Connecting Kit

Installation Instructions for  
Inter-Connecting 4' Kit (SFAM06) and 8' Kit (SFAM07)

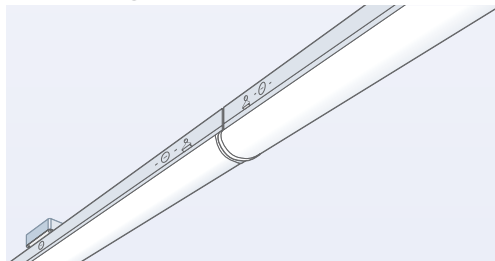

### WHAT COMES IN THE BOX

Linear Strip Fixture Harness Connecting Kit comes with the following standard parts:

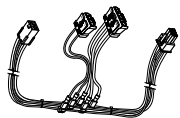

(1) 4' or 8' Harness



(2) Self-Adhesive Cable Ties-4'  
(4) Self-Adhesive Cable Ties-8'



(2) Split Grommets

#### WATTS

#### # OF STRIP FIXTURES THAT CAN BE CONNECTED

24W	55
30W	44
40W	33
50W	26
64W	20

Before Installation, carefully remove all parts from the packaging.

Inspect product for defects due to shipping.

Refer to Strip Fixture Installation Instructions for reference.

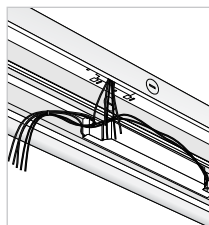
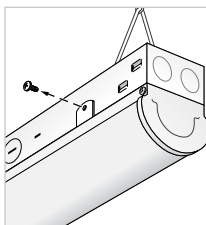

1. Turn off power at electrical panel.
2. Remove the screws from bracket side to allow the lamp to hang freely from the clips attached to the fixture to expose wiring.

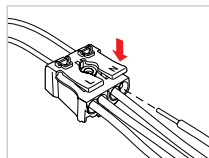
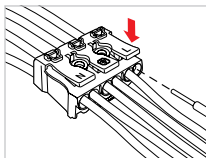

3. Connect wires from incoming power and lamp to harness:

Black = AC Line (L)  
White = AC Neutral (N)  
Green = Ground ( $\perp$ )

Purple = D + (L)  
Gray = D - (N)

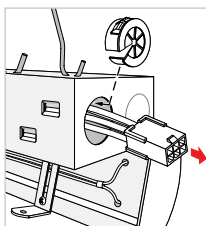

4. Remove knockout at end of fixture and feed female side of harness through hole. Place split grommet over wires and insert into opening.

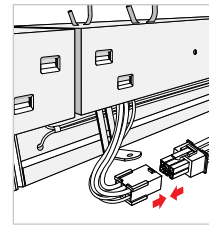
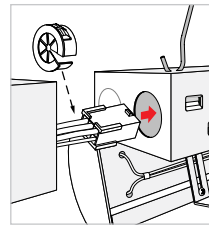

5. Remove knockout at end of the next in line Strip Fixture. Feed female side of harness through the hole and place 2nd split grommet over wires and insert into opening.
6. Mate the female side to the male side of 2nd harness inside of next fixture.

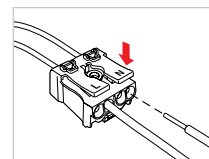
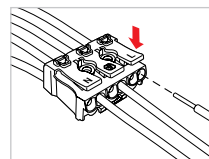

7. Connect lamp wires to harness based on Step 3.

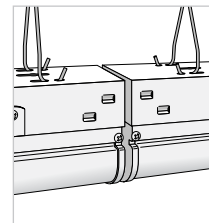
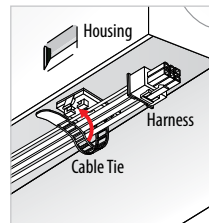

8. Use self-adhesive cable ties (included) to secure harness wires inside fixture to prevent from hanging excess. Close and secure both Strip Fixtures with screws. Adjust and align both units. Turn on the power and you are done.