

# EZ Hand Hygiene Dispenser

## LOADING INSTRUCTIONS

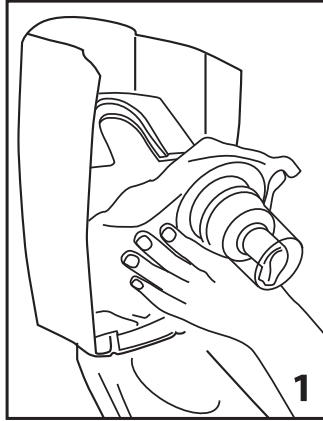

1 Load bottom of bag.

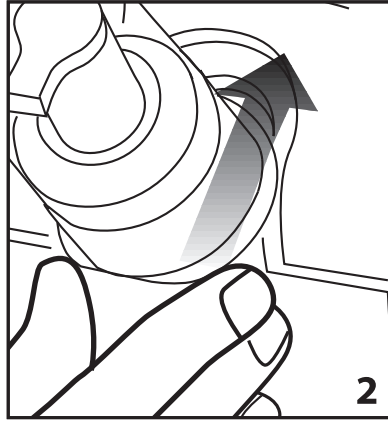

2 Slide bag collar over guide & push until firmly in place.

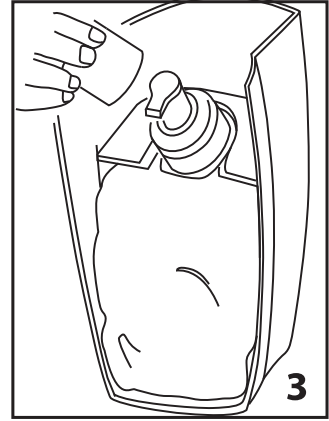

3 Remove cap.

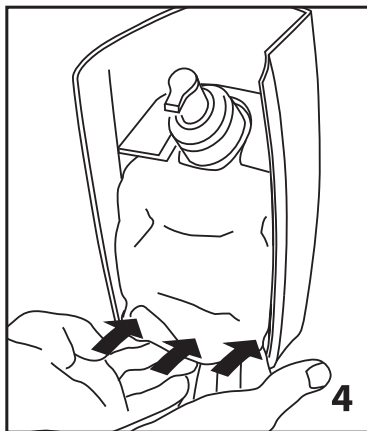

4 Make sure bag is pushed all the way in by pushing bottom corners in completely.

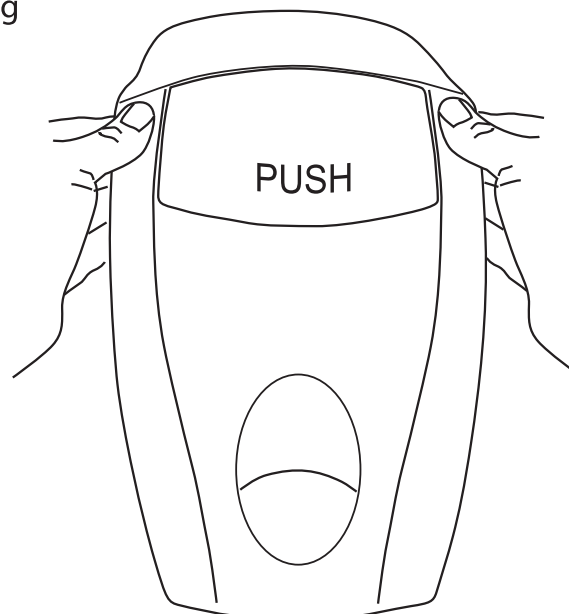

To close front panel, push on BOTH sides at top with thumbs as shown. Push with even pressure until closed tightly.

**DO NOT CLOSE BY PUSHING ON PUSH PAD!**